

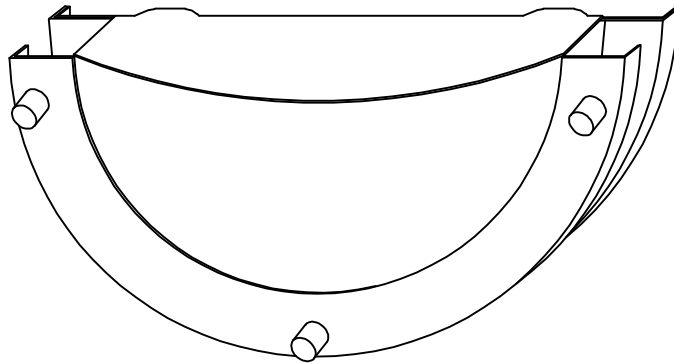

**PRODUCT NAME:LINEAR EE**  
**ITEM NUMBER:85550WTSN**

**Please consult your electrician for hanging fixture and wiring.**



**WARNING:Wires need to be connected to driver found in canopy and should not be connected directly to power source or a short may occur**

**85550WTSN : 1\*GU24\*13W**

**PRODUCT NAME: LINEAR EE**

**ITEM NUMBER: 85550WTSN**

**CAUTION:** Turn off the main power at the circuit breaker before installing and servicing the fixture to prevent possible injury from electric shock.

All electrical connections must be in accordance with local and National Electrical Code (N.E.C.) standards. If you are unfamiliar with proper electrical wiring connections, obtain the services of a qualified electrician.

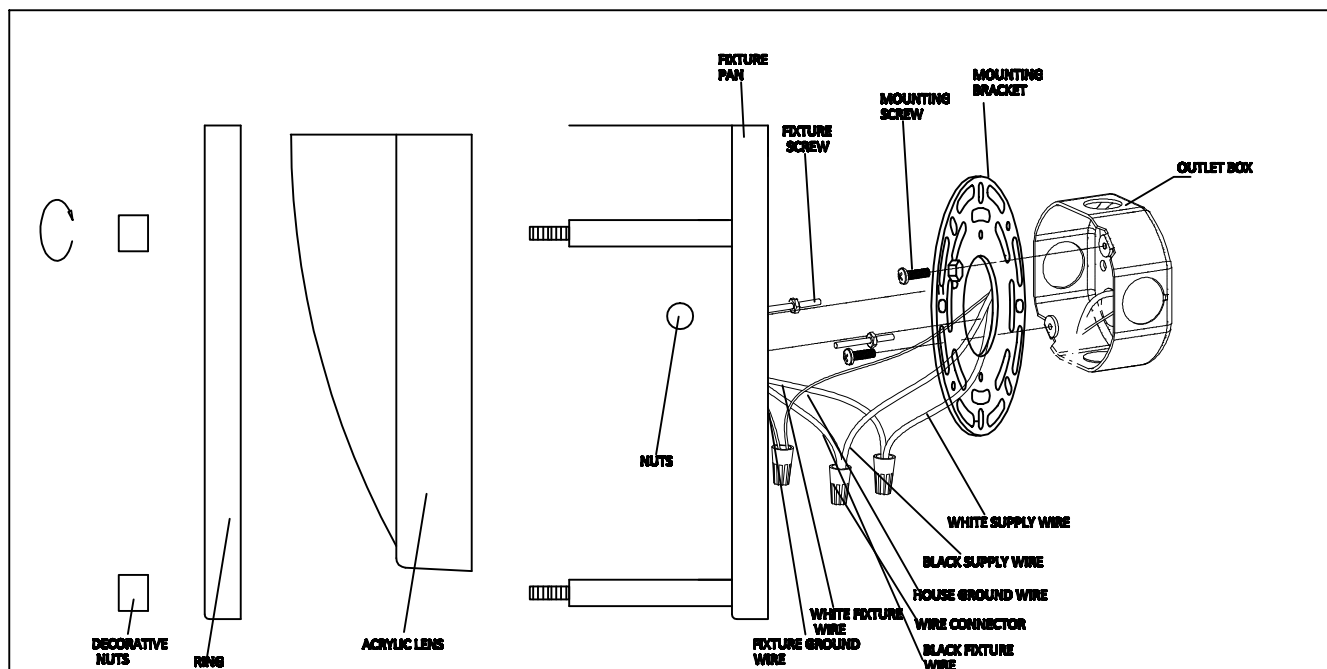

**1: Pull the SUPPLY WIRES and the HOUSE GROUND WIRE out from the OUTLET BOX and attach the MOUNTING BRACKET to the OUTLET BOX using the slotted holes on the MOUNTING BRACKET and the MOUNTING SCREWS provided.**

**2: Thread the FIXTURE SCREWS into the appropriate threaded holes of the MOUNTING BRACKET .**

**3: Connect the power supply wires to the fixture lead wires by connecting the BLACK FIXTURE WIRE to the BLACK SUPPLY WIRE , and the WHITE FIXTURE WIRE to the WHITE SUPPLY WIRE using WIRE CONNECTOR . Connect the fixture GROUND WIRE to the SUPPLY GROUND WIRE by fixed on the MOUNTING BRACKET .**

**4: Carefully tuck all wiring back into the OUTLET BOX. Place the fixture pan to wall mounting surface allowing for mounting screws to protrude through holes. Tighten the fixture pan to mounting bracket by using 2pcs of nut.**

**5: Final Assembly- Acrylic lens and ring in place by using 3pcs of the decorative nuts securely.**